

**STRONG
Bag Design!**

6 BAGS
For outdoor residential use.

Spectracide

Spectracide

BAG-A-BUG[®] **JAPANESE BEETLE TRAP₂** — REPLACEMENT BAGS —

- Disposable replacement bags are for use with your Bag-A-Bug[®] Japanese Beetle Trap₂.
- These bags limit your contact with the beetles.
- Use genuine Spectracide Bag-A-Bug Japanese Beetle Trap₂ Replacement Bags to ensure Japanese beetles are trapped.
- Spectracide Bag-A-Bug bags have an hourglass shape that traps thousands of beetles, preventing them from escaping.

DIRECTIONS

Attach a disposable bag to the yellow Bag-A-Bug trap vane assembly as shown. Gently push a small slit on the open end of the bag over each of the hooks on the vanes. Be careful not to tear or stretch the slits.

USE TIP

Drop a few small pebbles into the bag to stabilize the trap in windy conditions.

NOTICE: Buyer assumes all responsibility for safety and use in accordance with directions.

QUESTIONS & COMMENTS?

Call 1-800-917-5438 or visit our website at www.spectracide.com

Made in China
Manufactured for Spectrum Group
Div. of United Industries Corp.
PO Box 142642, St. Louis, MO 63114-0642
EPA Est. No. 81825-CHN-1
16-10118 © 2009 UIC

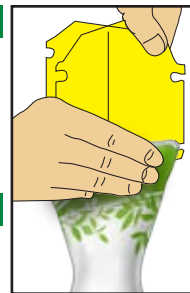

INSTRUCCIONES

Sujete una bolsa desechable al montaje de placas amarillas de la trampa Bag-A-Bug como se indica. Presione con cuidado una pequeña ranura en el extremo abierto de la bolsa sobre cada uno de los ganchos en las placas. Tenga cuidado de no rasgar ni estirar las ranuras.

CONSEJO PARA EL USO

Deje caer algunas piedritas pequeñas dentro de la bolsa para estabilizar la trampa cuando haya viento.

NOTA: El comprador asume toda la responsabilidad en caso de no seguir las instrucciones sobre seguridad y modo de empleo.

¿PREGUNTAS Y COMENTARIOS?

Llame al 1-800-917-5438.

PROOF OF PURCHASE

FPO only

071121 16903 7



BAG-A-BUG[®]

JAPANESE BEETLE TRAP₂

— REPLACEMENT BAGS —

Trampa para escarabajo japonés - Bolsas desechables

Traps 1,000s of Beetles Per Bag

Limits Your Contact
With the Beetles

Use With Spectracide[®] Bag-A-Bug[®]
Japanese Beetle Trap₂

**READY
TO USE**

CONTAINS 6 BAGS

8 1/2" x 17 7/8" (21.59 cm x 45.40 cm)