

Troubleshooting Guidelines

If the LED lights fall into the water: Although this LED light is waterproof, as a safety precaution, unplug all appliances before reaching into the water. Then, simply remove the LED Light from the water and attach it to the frame using the LED frame clip.

If the light does not turn on: Check to make sure the transformer is fully inserted into the outlet and the light switch is not set to the "Off" mode.

HELPFUL HINTS

To switch between light modes: Simply press the button on the light switch until you reach the desired light mode

- All Lights on (white, blue, and black LEDs are on)
- Blue Lights Only (blue LEDs are on)
- Black Lights Only (black LEDs are on)
- Blue/Black Light Fade (Blue and Black LEDs cycle)
- Off

The light will automatically remember the last active light mode if power is disconnected to the light. This feature was included for consumers who wish to use this light with a timer. Simply plug the light into your timer and select the desired light mode. Your light will turn on to the last mode selected.

The light should not be left on throughout the night, as fish benefit from alternating periods of light and darkness, just like people.

ONE YEAR LIMITED WARRANTY: United Pet Group (UPG), a division of Spectrum Brands, Inc., warrants this LED Light Stick Assembly against defects in material or workmanship for one year from the date of original purchase, subject to the conditions and exceptions stated below. Your sales receipt is your Proof-of-Date-of-Purchase. If the LED Stick Assembly exhibits such a defect, UPG will repair or replace it, at our option, without cost for parts or labor. The LED Stick Assembly must be shipped postage paid to UPG. Proof-of-Date-of-Purchase is required. You are responsible for proper shipping. Call Customer Service at 800-526-0650 for return authorization and shipping address. This warranty does not cover damage caused by accident, misuse, abuse or failure to follow the instructions accompanying this LED Stick Assembly. All implied warranties, including any implied warranty of merchantability or fitness for any purpose are limited to one year. Fish and plant loss, personal injury, property loss or damage (direct, incidental, or consequential) resulting from the use of this LED Light Stick are not covered by this warranty. Because some states/provinces do not allow the exclusion or limitation of incidental or consequential damages, or allow limitations on how long an implied warranty lasts, the above limitations or exclusion may not apply to you. This warranty gives you specific legal rights. You may also have other rights which vary from state/province to state/province.

IMPORTANT SAFETY INSTRUCTIONS

WARNING: To guard against injury, observe basic safety precautions, including the following:

READ AND FOLLOW ALL SAFETY INSTRUCTIONS

DANGER: TO AVOID POSSIBLE ELECTRIC SHOCK

Special care should be taken to avoid possible electric shock, since water is employed in the use of aquarium equipment. Do not attempt any repairs by yourself; return the appliance to an authorized service facility for service, or discard the appliance:

- If the appliance shows any sign of abnormal water leakage, immediately unplug it from the power source.
 - Carefully examine the appliance after installation. Unplug the appliance if there is water on parts not intended to get wet.
 - Do not operate any appliance if it has a damaged cord or plug, or if it is malfunctioning, or if it has been dropped or damaged in any manner.
 - Unplug ALL appliances before repositioning, cleaning, or removing the appliance.
 - To avoid the possibility of the appliance plug or receptacle getting wet, position the aquarium stand and tank to the side of a wall-mounted outlet in order to prevent water from dripping onto the plug or outlet. Arrange a "drip loop" for each cord connecting an aquarium appliance to an outlet. (See Illustration A.) The "drip loop" is the part of the cord below the level of the outlet that prevents water from traveling along the cord and coming in contact with the outlet. (If using an extension cord, the "drip loop" is located below the level of the connector.)
 - If the plug or outlet should get wet, do not unplug the cord. Disconnect the fuse or circuit breaker that supplies power to the appliance. Once the power has been disconnected, unplug the cord and examine it for the presence of water in the outlet.
- Always unplug the appliance from an outlet when it is not in use. Also unplug it before cleaning, and prior to disconnecting or attaching parts. Never yank the cord to pull the plug from the outlet. Grasp the plug and pull to disconnect.
- Do not use an appliance for anything other than its intended use. Do not use attachments that are not recommended or sold by the manufacturer; they may cause an unsafe condition.
- Do not install or store the appliance where it will be exposed to the weather or to temperatures below freezing.
- Make sure the appliance is securely installed before operating it.
- If an extension cord is necessary, use a cord with a rating that matches or exceeds the rating of the appliance. A cord rated for fewer amperes or watts than the appliance rating may overheat. Arrange the cord so that it will not trip anybody, or be pulled in any way.
- To avoid injury, do not touch hot or moving parts or hot parts such as heaters, reflectors, lamp bulbs, etc.
- Read and observe all notices on the appliance.
- Supervise children closely when they are near or using the appliance.

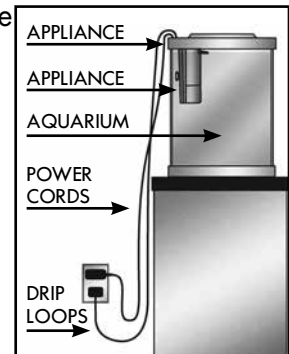

SAVE THESE INSTRUCTIONS

Start Here - LED Light Sticks

Quick Setup Guide

1

Parts Check

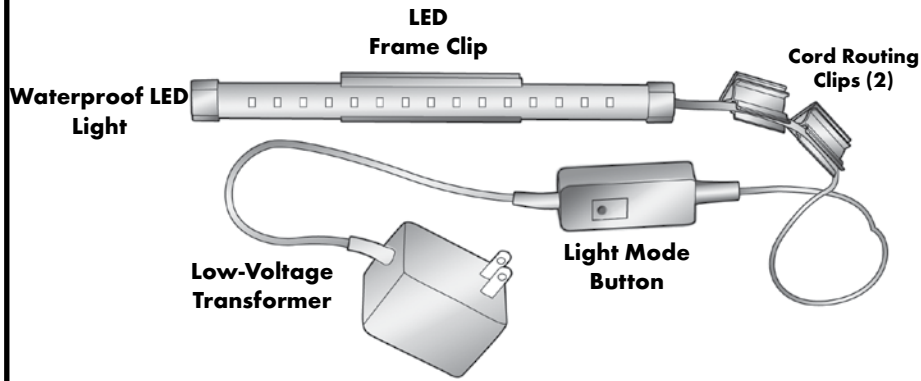

Note: Some models have two LED lights

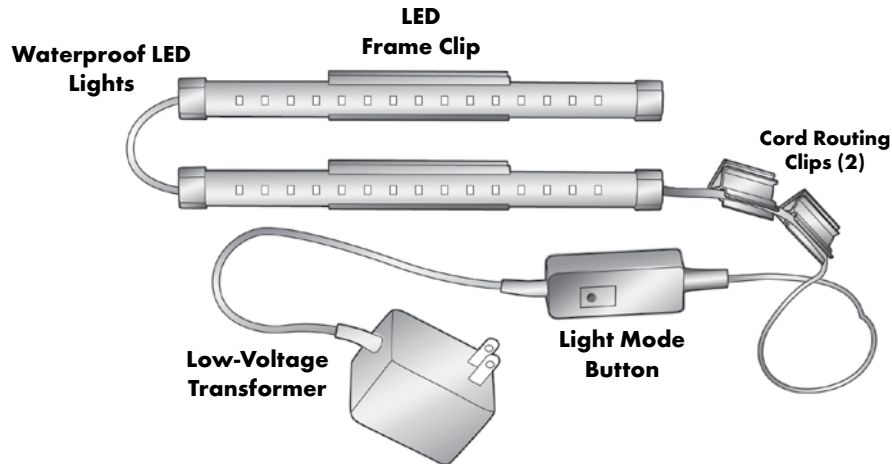

Questions or Missing Parts Call Customer Service (800) 526-0650

8:00 a.m. - 5:30 p.m. M-F, EST www.tetra-fish.com

GLOFISH is a ® Registered Trademark of Yorktown Technologies, L.P., and is used under license.

© 2016 Yorktown Technologies, L.P.

2

Install LED Light

A. Clip Waterproof LED Light into the front of the aquarium frame.

C. Plug in and make a drip loop for safety.

B. Hide wires with cord routing clips.

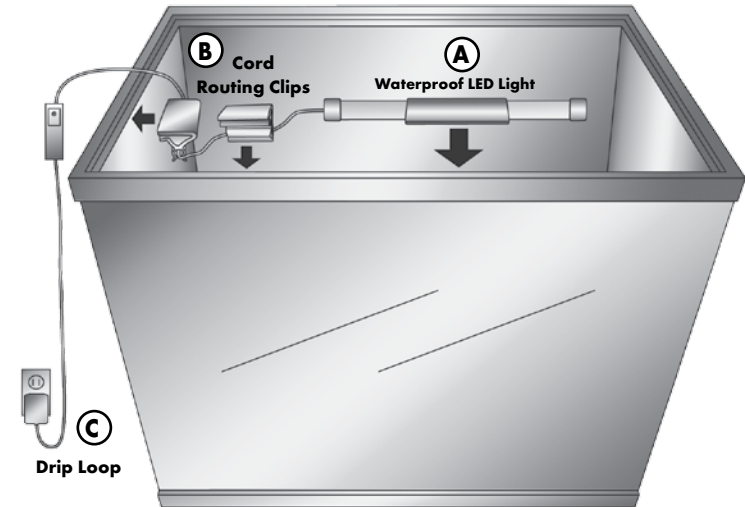

Note: Note for 2 x 10" model: If your larger tank has a Center Brace, simply route the Connecting Wire **under** the tank's center brace (see diagram below).

